



7/16 系列连接器界面依照DIN标准。一般为中大功率场合而设计。如蜂窝网基站，控制单元，天线及广播设备等。7/16系列产品通过接触面三元合金电镀来减少互调失真。六角形螺母可以用扳手拧紧，提供更稳固的连接面而进一步减少信号畸变。每个接触对的互调失真性能均优于是150dBm，公制 M29 x 1.5的螺纹结构确保了坚固的连接。7-16系列的产品可以适用多种常用尺寸的RG电缆及低损耗电缆，且有焊接装接及焊接压接两种方式

7/16 Series connector' s interface was designed according to DIN (Deutsh Industries Norm). Its name derives from the metric dimensions of the connector interface: 7mm OD of inner contact, 16 mm IDof outer contact. 7/16 connectors are designed for use in communications systems, with power levels of 100 watts per channel.Interface dimensions confirmable to the Standards: IEC 169-4 CECC 22190 DIN47223



主要技术特性		KEY PERFORMANCE	
温度范围 Temperature range	-40 ~ + 85℃	绝缘电阻 Insulation resistance	≥ 10000MΩ
特性阻抗 Characteristic impedance	50Ω	介质耐压 Dielectric Withstanding Voltage	4000V rms
频率范围 Frequency range	0-7.5GHz	电压驻波比 VSWR	≤ 1.30
工作电压 Voltage rating	2700V rms	内导体保持力 Center Contact retention force	≥ 6N
接触电阻 Contact resistance	中心导体 Center conductor	寿命 Durability	500 Cycles
	外导体 Outer conductor		

材料与涂覆	MATERIAL AND PLATING
壳体 Body	黄铜镀镍 Brass,nickel plated
插针 Male center contacts	黄铜镀硬金 Brass,gold plated
插孔 Female center contacts	铍青铜或锡青铜镀硬金 Beryllium copper or phosphor bronze ,gold plated
绝缘体 Insulators	聚四氟乙烯 PTFE
压接套 Crimp ferrules	铜合金镀镍 Copper alloy, nickel plated



界面尺寸 (mm) Interface Dimensions in mm

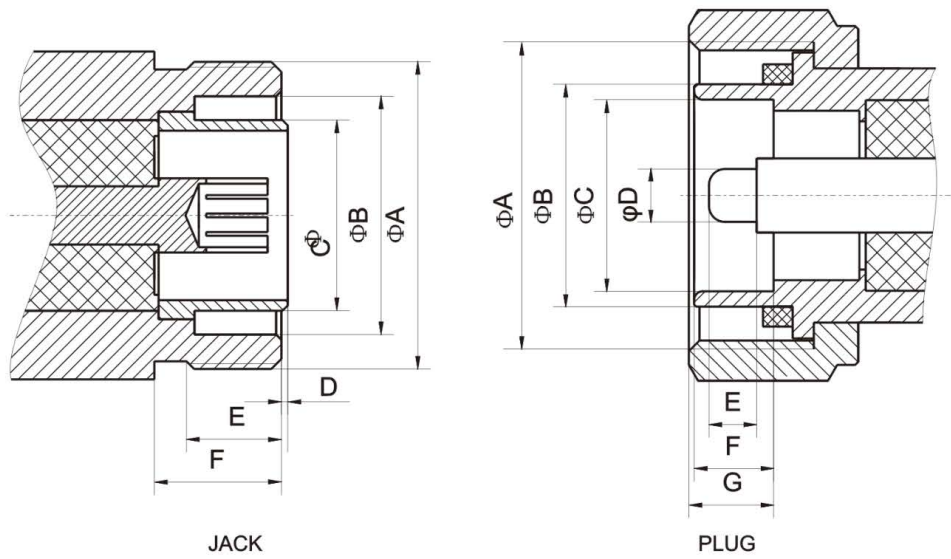

代号 Letter	插座 / Jack(female)		插头 / Plug(male)	
	最小 Minimum	最大 Maximum	最小 Minimum	最大 Maximum
A	M29X1.5		M29X1.5	
B	22.1	22.9	20.6	21.4
C	17.84	18.02	18.03	18.21
D	0.50	0.60	4.96	5.04
E	8.10	-	-	4.50
F	10.00	-	7.00	8.00
G			7.00	9.00



1. 半刚电缆连接器 Semi-rigid Cable connectors

直式半刚电缆插头 Straight Cable Plugs

产品编码 Product No.	产品名称 Product type	适用电缆 Apply cable	备注 Notes
281B-7101	L29-JB6	.250	

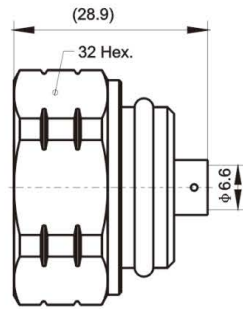

2. 软电缆连接器 Flexible Cable connectors

直式软电缆插头 Straight Cable Plugs

产品编码 Product No.	产品名称 Product type	适用电缆 Apply cable	备注 Notes
281B-7001	L29-J7DY	7/50D	

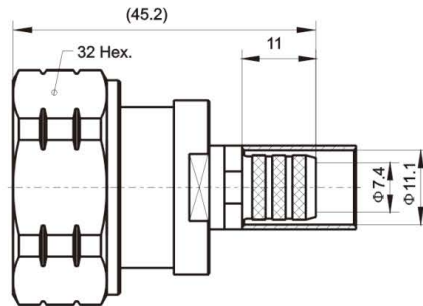

弯式软电缆插头 Right Angle Cable Plugs

产品编码 Product No.	产品名称 Product type	适用电缆 Apply cable	备注 Notes
283B-7001	L29-JW7DY	7/50D	

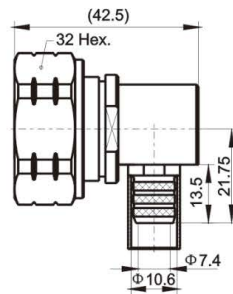

直式穿墙安装电缆插座 Straight Bulkhead Cable Jacks

产品编码 Product No.	产品名称 Product type	适用电缆 Apply cable	安装尺寸 Mounting Hole
283B-2001	L29-KY7DY	7/50D	H109

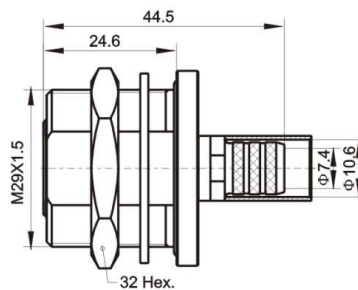

3. 面板安装连接器 Flange Mount connectors

面板安装电缆插座 Straight Bulkhead Cable Jacks

产品编码 Product No.	产品名称 Product type	安装尺寸 Mounting Hole	备注 Notes
283B-1301	L29-KFD	H108	

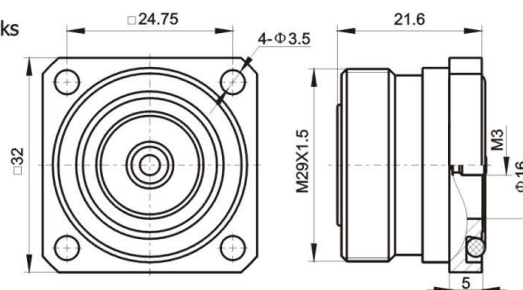



4. 转接器 Adaptors

转接器 L29/N-JJ

产品编码 Product No.	产品名称 Product type
2728-B711	L29/N-JJ

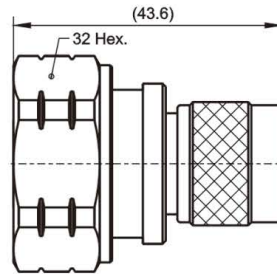

转接器 L29/N-JK

产品编码 Product No.	产品名称 Product type
2728-B721	L29/N-JK

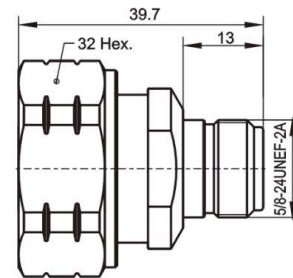

转接器 L29/N-KJ

产品编码 Product No.	产品名称 Product type
2728-B721	L29/N-KJ

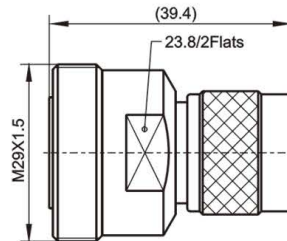

转接器 L29/N-KK

产品编码 Product No.	产品名称 Product type
2728-B731	L29/N-KK

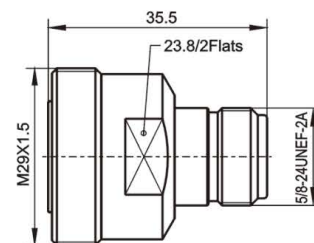

5. 护帽 Dust caps

产品编码 Product No.	备注 Notes
2881-E301	L=100 A=7

